



# RUMORS POSTAL SERVICE

Zea Quill

Marvin Ridge highschool

11<sup>th</sup> grade

# Concept Treatment

Step past the front lawn into the haunted tale behind the neighborhood's most infamous address. stationed just outside the entrance and exit of this haunted house. The Rumors Postal Service merchandise cart delivers more than just souvenirs. It delivers secrets.

Come meet our charming postal crew, as this cart serves as a narrative-driven outpost where guests can uncover clues about the previous family who met their demise under suspicious circumstances. Each one of our workers has a story to tell, sharing unsettling rumors they've gathered from countless deliveries to the cursed home.

Our cart offers a selection of themed trinkets, apparel, and "unclaimed mail" that ties directly into the house's story! Perfect trophies for those who survive that eerie home. This cart doubles as a landmark, a storytelling hub, and a commercial point of sales. That blurs the line between retail and immersive horror.

Enter that house with caution. And if you make it out, don't forget to tell us what you see, because we love to spread rumors...



# Inspiration





# Sketches



These ideas turn my initial designs and problem solving into a practical yet creditable vision

# Final

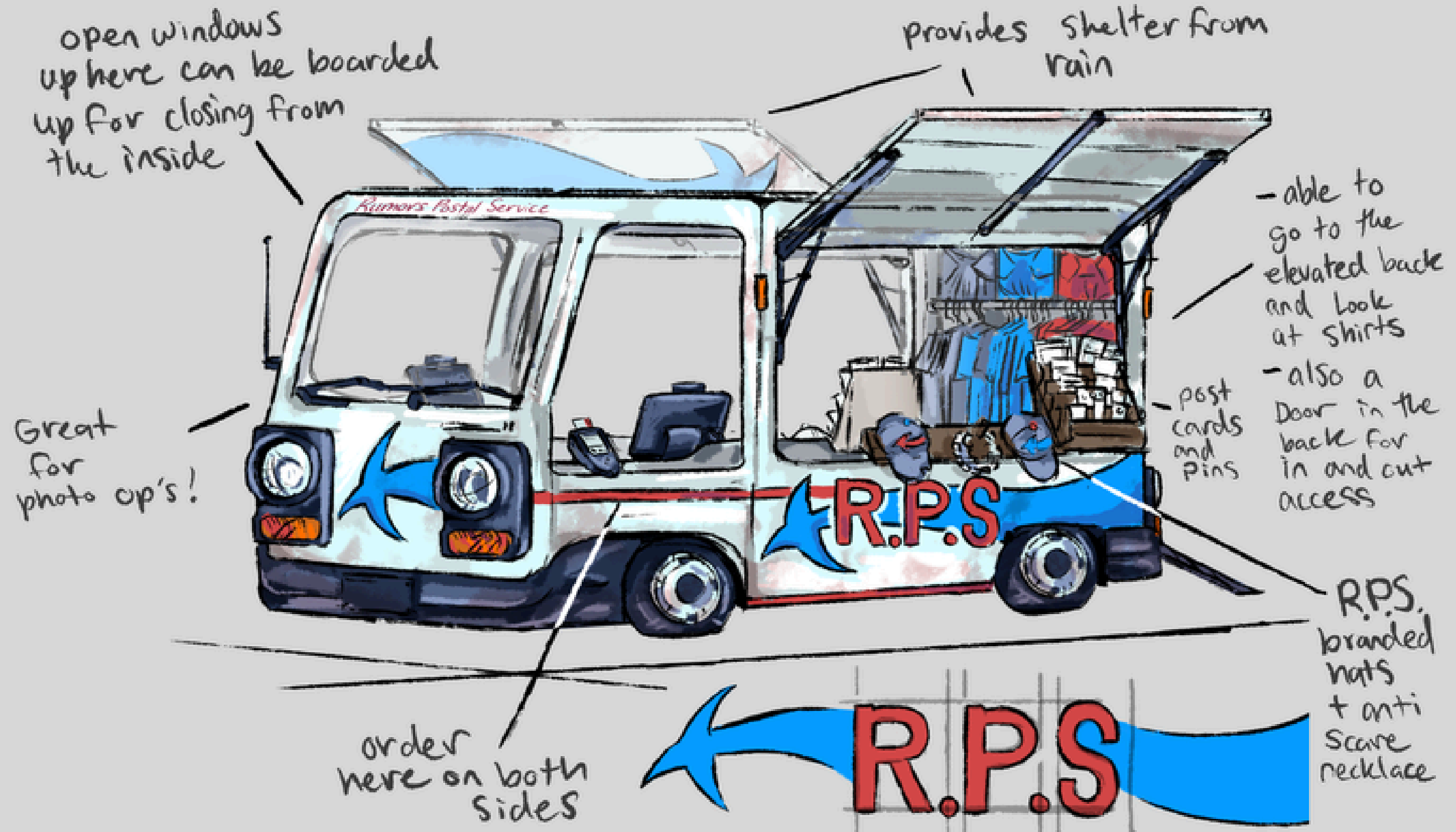

# Ground plan

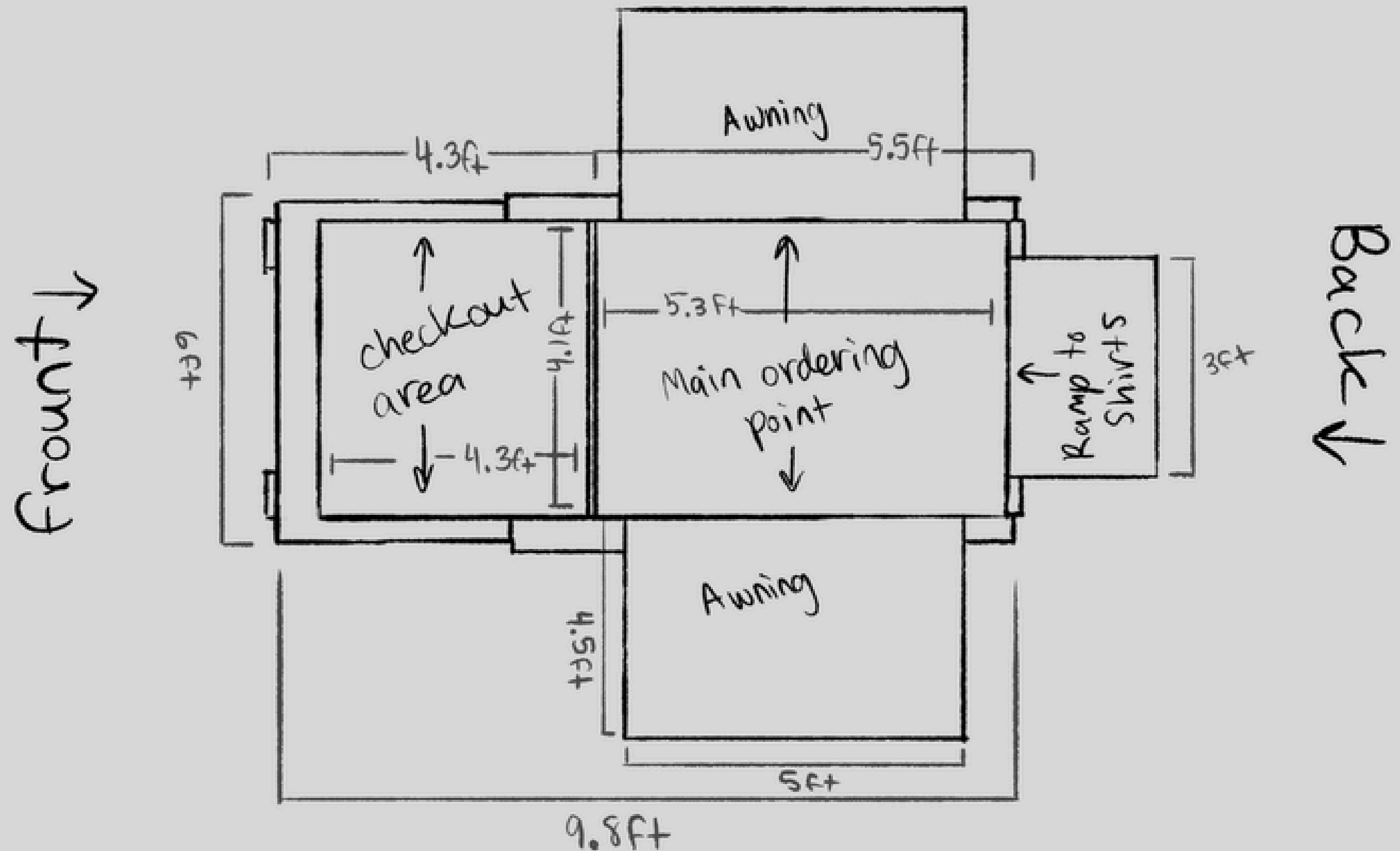





# Character

Meet Riley!

He's one of our amazing staff members here at Rumors Postal Service. He loves to deliver his route, and investigating the secrets of that mysterious house. If you have any information, never be shy to tell Riley any rumors you know!

